

# COURTYARD<sup>®</sup> Marriott<sup>®</sup>

## TORONTO NORTHEAST/MARKHAM



EASTON'S BOARDROOM



COURTYARD BISTRO



COURTYARD LOUNGE



DON VALLEY ROOM



CONFERENCE RECEPTION FOYER



MARKHAM BALLROOM



FRONT DESK



WOODBINE ROOM

Function Space	Dimension (sq.ft.)	Total Sq.Ft.	Theatre	Classroom	HollowSquare	U-Shape	Boardroom	Rounds of 6	Rounds of 8	Rounds of 10	Reception
<b>LOWER LEVEL</b>											
EASTONA	13'X20'X7'10"	260	-	-	-	-	10	-	-	-	-
EASTON B	14'X26'X7'10"	364	-	-	-	-	12	-	-	-	-
DON VALLEY A	40'X29'X10'	1160	50	27	24	18	18	30	40	50	50
DON VALLEY B	40'X25'X10'	1000	50	27	24	18	18	30	40	50	50
DON VALLEY A & B	40'X54'X10'	2160	100	60	54	42	42	60	80	100	100
MARKHAM	58'X68'X10'	3944	300	135	66	60	42	144	192	240	300
<b>LOBBY LEVEL</b>											
WOODBINE A	48X41'X10'	1968	170	60	42	33	18	72	96	120	180
WOODBINE B	48'X27'X10'	1296	120	48 Facing Serving 60 Facing Window	36	30	18 Facing Serving 24 Facing Window	48	64	80	120
WOODBINE A & B	48'X71'X10'	3264	300	144	78	60	42 (Facing Serving)	144	192	240	300

\*Please note: these numbers are subject to change based on the final set-up of the room with any additional requirements. E.g. Audio-Visual, elaborate décor & staging etc.

Contact the experts at 905-307-3044 in order to choose the perfect room for your event/meeting!

# COURTYARD<sup>®</sup> Marriott<sup>®</sup>

Lower Level

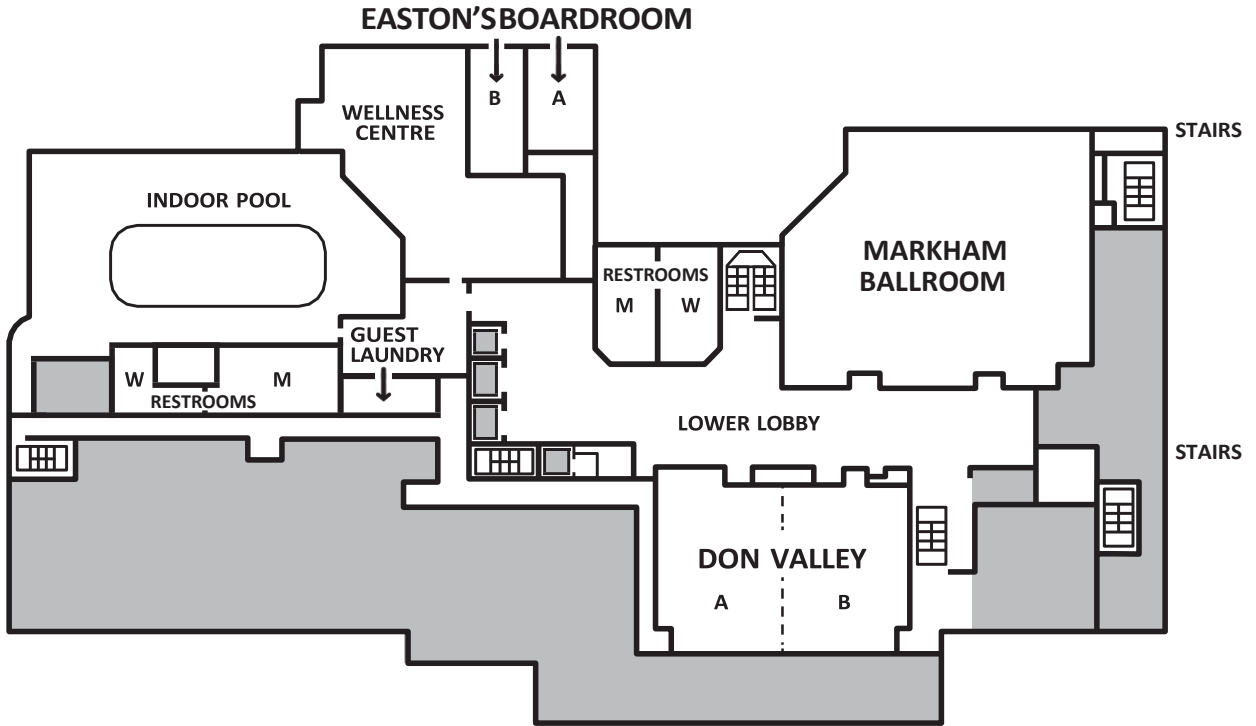

Main Floor

